

INFRARED THERMOMETER

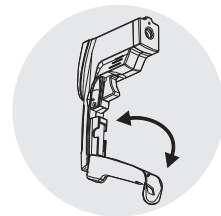

High Temperature IR Thermometer 8895

- Designed for temperature up to 816 °C
- Built-in laser pointer (670nm, <1mw) to improve aim
- Quick response: 500ms
- Adjustable emissivity from 0.3 to 1.0
- D:S ratio is 12:1
- Easy flip battery compartment design

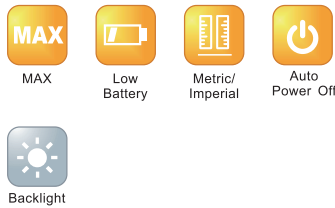

EMISSIVITY VALUES

Emissivity Values-Non-Metals
Refractory & Building Materials

SURFACE	EMISSIVITY
Red brick (rough)	0.75 to 0.9
Fire clay	0.75
Asbestos	0.95
Concrete	0.7
Marble	0.9
Carborundum	0.85
Plaster	0.9
Alumina (fine grain)	0.25
Alumina (coarse grain)	0.45
Silica (fine grain)	0.4
Silica (coarse grain)	0.55
Zirconium silicate up to 500°C	0.85
Zirconium silicate at 850°C	0.6
Quartz (rough)	0.9
Carbon (graphite)	0.75
Carbon (soot)	0.95
Timber (various)	0.8 to 0.9
Plastics films (.05 mm thick)	0.5 to 0.95
Polythene film (.03 mm thick)	0.2 to 0.3
Rubber (smooth)	0.9
Rubber (rough)	0.98
Plastics (varous, solid)	0.8 to 0.95
Plastics films (.05 mm thick)	0.5 to 0.95
Polythene film (.03 mm thick)	0.2 to 0.3
Paper and cardboard	0.9
Silicone polish	0.7
Miscellaneous	
Enamel (any color)	0.9
Oil paint (any color)	0.95
Lacquer	0.9
Matte black paint	0.95 to 0.98
Aluminum lacquer	0.5
Water	0.98
Rubber (smooth)	0.9
Rubber (rough)	0.98
Plastics (varors, solid)	0.8 to 0.95

*Emissivity varies with purity

Ordering Code

VZ8895AZ, 8895 IR Thermometer

Model	8895
Temp. range	-40~816°C
Temp. resolution	0.1°C/°F(<300°C), 1°C/°F(>300°C)
Temp. accuracy (Which is greater)	<0°C : +/-2°C ; 0~300°C: +/-2% or 2°C 300~500°C: +/-2.5% ; >500°C: +/-3%
Repeatability	+/-1°C
Emissivity	0.3~1.0 Adjustable
D:S ratio	12:1
LCD size	34(H)x37(W)mm
Operating temp.	10~40°C
Operating RH%	Humidity < 80%
Storage temp.	-20~50°C
Storage RH%	Humidity < 90%
Dimension	195x134x50 mm
Weight	240g
Battery	AA battery x 2pcs
Standard Package	Meter/Battery/Manual/Hard carry case Wrist strap/ Soft carry pouch



POUCH (SOFT CARRY CASE)
P/N: VM68895AL
COLOR: BLACK
SIZE:200X133X42MM



STRAP (WRIST STRAP)
P/N: VM68886A
COLOR: BLACK
SIZE:~220MM

